

SAW - Serialization Aggregation Workstation

The Serialization Aggregation Workstation was designed as an offering to the pharmaceutical packaging operations that don't have the demand nor the desire to install a fully integrated case packing operation that is compliant with the current Serialization and aggregation requirements.

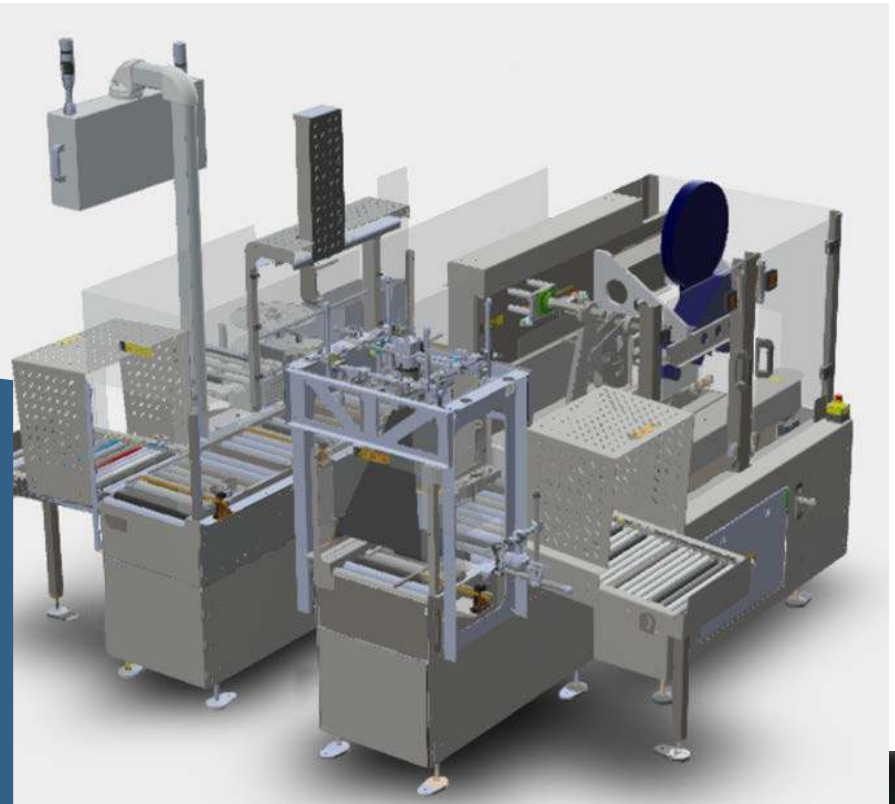

Efficient and Productive: The SAW replaces manual, time-consuming, aggregation processes that often only allow for speeds of 1-2 cases per minute. With a throughput of up to 10 cases per minute, productivity in this area of the packaging process could be increased by as much as 500%.

Flexible Modular Design: The SAW is designed to be flexible with its dual modules. Depending on options and process requirements, the unit can be placed in multiple design configurations to fit your specific end-of-line packaging needs.

Effective: Using an association approach to aggregation, the SAW aligns the process steps of case packing with the aggregation needs of the serialization equipment to ensure proper aggregation to the case level.



SERIALIZATION AGGREGATION WORKSTATION SPECIFICATIONS

Capabilities

- Case Size Range Capabilities (+/- 1/8")
Width = 4" to 11.75" (100mm to 300mm)
Length = 6" to 13" (150mm to 330mm)
Height = 4" to 9.5" (100mm to 250mm)
- Throughput of up to **10 cases per minute**
- Case Label Print and Apply for up to a 4" x 10" Wrap-Around Label
- Case Label Print Quality Verification by Integrated Vision System
- Aggregation Verification by Integrated Vision System

Standard Features

- Optel Pharma-Proof Vision System
- Domino M Series Print and Apply Corner Wrap Labeler
- Backing Plate for Label Application
- Powered Roller Conveyor with Positive Stops for each zone
- Adjustable HMI Support Arm, sized for dual HMIs (SAW and Vision system)
- Powered Roller Conveyor with Pop-up Stops for each zone
- Under Conveyor Mounted Reject Cylinders
- Label Verification Post-Application
- Top Flap Closing and Taping System
- Allen Bradley CompactLogix PLC with Plus 7 Color Touch-Screen
- Allen Bradley PowerFlex 525 Variable Frequency Drives (VFDs)

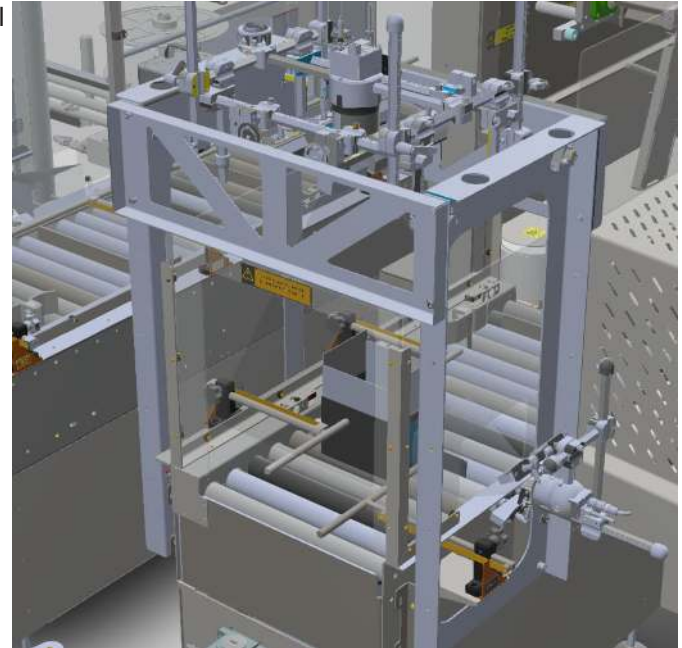

Common Options

- In-feed and/or Out-Feed Conveyor Extension
- Application-Specific Case Packing Conveyor
- Application-Specific Bottle Transfer Conveyor
- Additional E-Stops
- FAT, SAT and IQ/OQ Protocols
- Installation Assistance, Commissioning and Training
- Customer Specified Vision System
- Most any Customization

Main Power Options

- 230 VAC 3 Phase 60 Hz
- 460 VAC 3 Phase 60 Hz
- 575 VAC 3 Phase 60 Hz (Canada)
- 220 VAC Single Phase 50 Hz (International)
- 380 VAC 3 Phase 50 Hz (International)

APPLICATION EXAMPLE

